

9616/9617/9619 SERIES

Slider lock type FPC/FFC Connectors



- 1.0mm pitch SMT
- Slider lock (ZIF) Type
- Straight/Right Angle type

The 9616/9617/9619 series is a 1.0mm-pitch SMT FPC/FFC connector. This item is consisted with the slider lock structure which locks the card when inserted. Insertion force is low when the card is inserted, which refers to our Zero Insertion Force (ZIF) type. It also have a wide variety from Right Angle/Straight type and top and bottom contact, which allows us to provide a suitable FPC/FFC connector for you, in accordance with PCB design.

Features

- Slider lock type with clear tactile feel for better workability.
- Wide variety in Connection type and contact structure
- Compliant with RoHS

Specifications

1	Series No.	9616	9617	9619
2	Pitch	1.0mm	1.0mm	1.0mm
3	No. of contact	4~40P	4~40P	4~40P
4	Connection type	Right Angle (RA)	Right Angle (RA)	Straight (ST)
5	Contact structure	Top	Bottom	Single
6	Product height	2.5mm	2.5mm	4.8mm
7	Current rating	1.0A	1.0A	1.0A
8	Voltage rating	125V (AC, DC)	125V (AC, DC)	125V (AC,DC)
9	D.W. voltage	AC250V (1min)	AC250V (1min)	AC250V (1min)
10	Insulation Resistance	100MΩ or more	100MΩ or more	100MΩ or more
11	Contact Resistance	30mΩ or below	30mΩ or below	30mΩ or below
12	Operating temperature	-40°C~+105°C	-40°C~+105°C	-40°C~+105°C
13	Plating	Au plating over Ni	Au plating over Ni	Au plating over Ni
14	FPC Thickness	0.3mm	0.3mm	0.3mm
15	Lock type	Slider lock	Slider lock	Slider lock

Website

http://www.iriso.co.jp/en/product_series/9616/

http://www.iriso.co.jp/en/product_series/9617/

http://www.iriso.co.jp/en/product_series/9619/

9616 SERIES

IMSA-9616S-**-□-□□

SERIES 9616 SOCKET

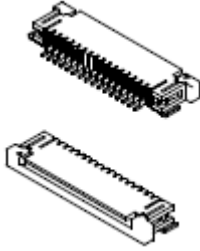

CKT	PARTS No.	A	B	C	D
4	9616S-04*-***	3	8.7	10.3	3.2
5	9616S-05*-***	4	9.7	11.3	4.2
6	9616S-06*-***	5	10.7	12.3	5.2
7	9616S-07*-***	6	11.7	13.3	6.2
8	9616S-08*-***	7	12.7	14.3	7.2
9	9616S-09*-***	8	13.7	15.3	8.2
10	9616S-10*-***	9	14.7	16.3	9.2
11	9616S-11*-***	10	15.7	17.3	10.2
12	9616S-12*-***	11	16.7	18.3	11.2
13	9616S-13*-***	12	17.7	19.3	12.2
14	9616S-14*-***	13	18.7	20.3	13.2
15	9616S-15*-***	14	19.7	21.3	14.2
16	9616S-16*-***	15	20.7	22.3	15.2
17	9616S-17*-***	16	21.7	23.3	16.2
18	9616S-18*-***	17	22.7	24.3	17.2
19	9616S-19*-***	18	23.7	25.3	18.2
20	9616S-20*-***	19	24.7	26.3	19.2
21	9616S-21*-***	20	25.7	27.3	20.2
22	9616S-22*-***	21	26.7	28.3	21.2
23	9616S-23*-***	22	27.7	29.3	22.2
24	9616S-24*-***	23	28.7	30.3	23.2
25	9616S-25*-***	24	29.7	31.3	24.2
26	9616S-26*-***	25	30.7	32.3	25.2
27	9616S-27*-***	26	31.7	33.3	26.2
28	9616S-28*-***	27	32.7	34.3	27.2
29	9616S-29*-***	28	33.7	35.3	28.2
30	9616S-30*-***	29	34.7	36.3	29.2
32	9616S-32*-***	31	36.7	38.3	31.2
33	9616S-33*-***	32	37.7	39.3	32.2
34	9616S-34*-***	33	38.7	40.3	33.2
35	9616S-35*-***	34	39.7	41.3	34.2
36	9616S-36*-***	35	40.7	42.3	35.2
40	9616S-40*-***	39	44.7	46.3	39.2

*If there is any inquiries about No. of contacts, please contact us

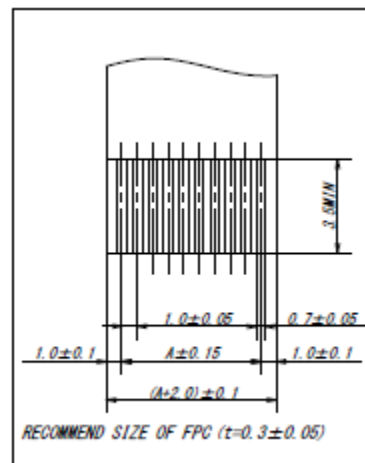
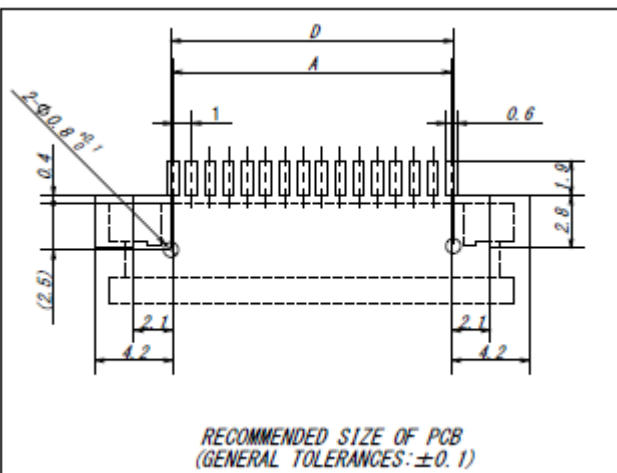
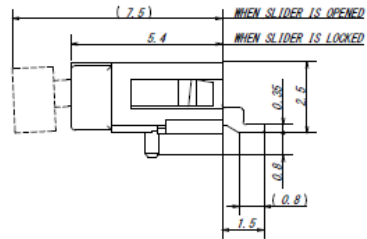
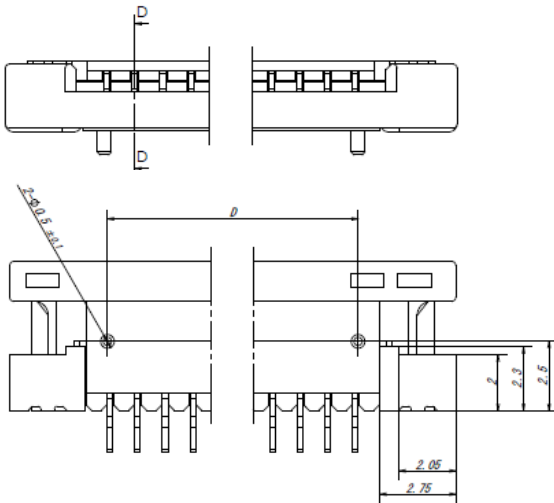
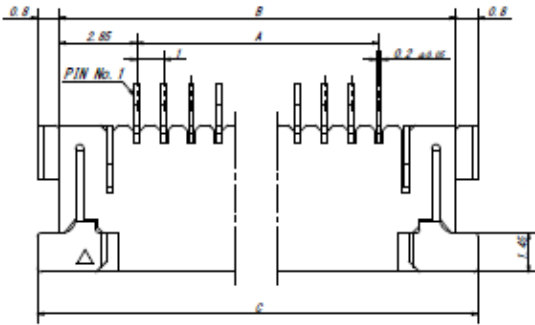

9619 SERIES

IMSA-9619S-**-□-□□

SERIES 9619 SOCKET

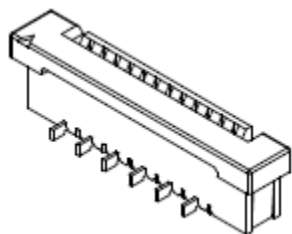

CKT	PARTS No.	A	B	C
4	9619S-04*-***	3.0	7.3	5.7
5	9619S-05*-***	4.0	8.3	6.7
6	9619S-06*-***	5.0	9.3	7.7
7	9619S-07*-***	6.0	10.3	8.7
8	9619S-08*-***	7.0	11.3	9.7
9	9619S-09*-***	8.0	12.3	10.7
10	9619S-10*-***	9.0	13.3	11.7
11	9619S-11*-***	10.0	14.3	12.7
12	9619S-12*-***	11.0	15.3	13.7
13	9619S-13*-***	12.0	16.3	14.7
14	9619S-14*-***	13.0	17.3	15.7
15	9619S-15*-***	14.0	18.3	16.7
16	9619S-16*-***	15.0	19.3	17.7
17	9619S-17*-***	16.0	20.3	18.7
18	9619S-18*-***	17.0	21.3	19.7
19	9619S-19*-***	18.0	22.3	20.7
20	9619S-20*-***	19.0	23.3	21.7
21	9619S-21*-***	20.0	24.3	22.7
22	9619S-22*-***	21.0	25.3	23.7
23	9619S-23*-***	22.0	26.3	24.7
24	9619S-24*-***	23.0	27.3	25.7
25	9619S-25*-***	24.0	28.3	26.7
26	9619S-26*-***	25.0	29.3	27.7
27	9619S-27*-***	26.0	30.3	28.7
28	9619S-28*-***	27.0	31.3	29.7
29	9619S-29*-***	28.0	32.3	30.7
30	9619S-30*-***	29.0	33.3	31.7
31	9619S-31*-***	30.0	34.3	32.7
32	9619S-32*-***	31.0	35.3	33.7
34	9619S-34*-***	33.0	37.3	35.7
36	9619S-36*-***	35.0	39.3	37.7
38	9619S-38*-***	37.0	41.3	39.7
40	9619S-40*-***	39.0	43.3	41.7

*If there is any inquiries about No. of contacts, please contact us

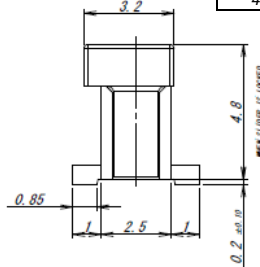
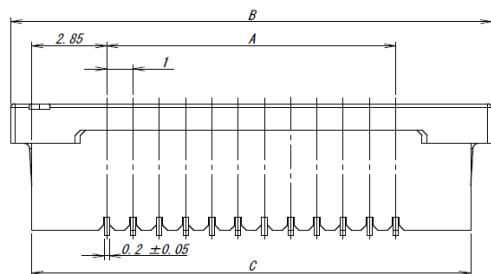
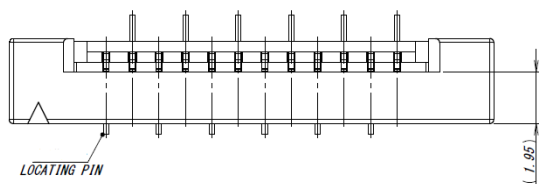

NOTE

1. MAXIMUM RATING VOLTAGE : 125V (AC, DC)
2. MAXIMUM RATING CURRENT : 1A
3. COPLANARITY : 0.1MAX
4. THIS PRODUCT UTILIZES LEAD-FREE TIN PLATING. ANY PRODUCT WITH LEAD-FREE TIN PLATING IS SUSCEPTIBLE TO TIN WHISKER. IRISO PROVIDES NO ASSURANCES AGAINST THE GROWTH OF TIN WHISKER EVEN UNDER NORMAL OPERATING CONDITIONS. CUSTOMERS ASSUME ALL RESPONSIBILITY FOR ANY PRODUCT FAILURES DUE SOLELY TO THE GROWTH OF TIN WHISKERS.

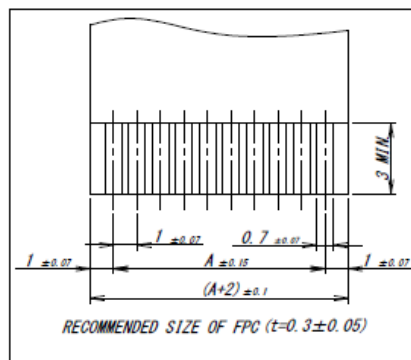
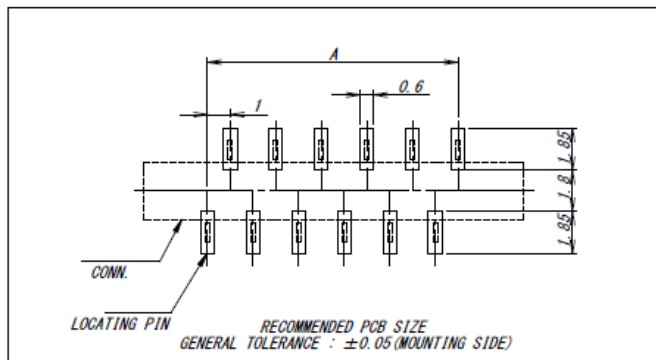

IRISO U.S.A., INC.

*Specification is subject to change without prior notice for improving performance of the product and so on.

*Dimension and specification described herein are limited to major items. When applying the products, please confirm details on drawing and specification sheets which will be provided upon request.