

11600 Series - FPC/FFC Auto I-Lock Type Connector -

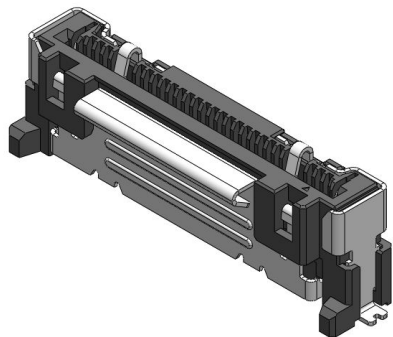

The 11600 Series is a 0.5mm pitch NON-ZIF ST type FFC connector. Compatible with FFC with shield that enables high-speed transmission of digital signals. A shield is attached and EMC measures are also taken.

The optimized contact structure supports up to 20Gbps transmission range by selecting FFC. (Representative reference value defined by the company) Impedance matching: Differential 100Ω

It has the "Auto I-Lock" structure unique to Iriso that locks automatically when the FFC card is inserted. As a robot assembly compatible connector, it contributes to assembly automation.

【Target Application】

ADAS (sensing devices), infotainment (cockpits), home appliances, Commercial appliances, communications equipment, industrial equipment, robots

Auto I-Lock™

This series adopt IRISO original technology "Auto I-Lock™ *1", it is able to eliminate the process of opening and closing of the slider or cover to lock FPC/FFC, and it is automatically locked when you insert the FPC/FFC card.

This function prevent slanted insert or incomplete mating, therefore improve the workability.

(Press upper surface of the lever to unlock.)

(*1) Auto I-Lock is a registered trademark of IRISO Electronics Co., Ltd.

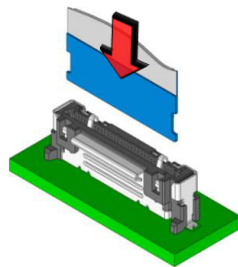

High Speed

The demand for high-frequency component signals is omnipresent. Ever advancing technology requires modern devices to have high-speed and reliable transmission from its connected components. IRISO has met this challenge by combining our floating connectors with high-speed transmissions technology.

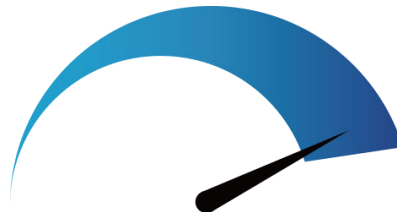

Robot Automation

Automated assembly not only cuts labor costs, but it increases quality. Certain automation, however, can have adverse effects like adhesion of foreign matter, mounting/mating misalignments, and incomplete mating. To overcome these issues, IRISO has launched the "Robot Assembly Compatible Connector" concept to solve these automated assembly problems.



IMSA-11600S-~~XX~~Y9~~XX~~

Product Spec

Item	Unit	Specification
Pitch	mm	0.5
Lock	mm	Auto I-Lock
Mating height	mm	-
Pin Counts	ckt	8~60
Mount Type	-	Straight
Operating Temperature Range	℃	-40~+105
Rated Current	A	0.5
Rated Voltage	V	50
Contact Resistance	mΩ	40
Withstand Voltage	V	250
Durability (Insertion/Withdrawal)	times	20

* For packaging info, please refer to our packaging drawing.
* Contents are subject to change without prior notice, due to our quest for improving product performance. Dimensions and specifications described herein are limited to major items. For more details on how to use this connector, please request a drawing and specification sheet. *Specifications may be subject to changes without prior notice, due to our quest for improving product performance.

* 掲載している内容・仕様・数値は、概略のものであり、予告無しに変更されることがあります。
* ご使用の際は、最新の図面・仕様書をお取り寄せ頂き、正しくご使用下さい。ご不明な点などございましたら、弊社営業担当にご相談ください。
* 製品の梱包については図面をご確認ください

Plug

Parts	Material	Plating
Housing	-	-
Retainer	-	-
Contact	-	-
Metal Flange	-	-

Socket

Component	Material	Plating
Housing	LCP	—
Contact	Corson Alloy	Gold
Metal Flange	Phosphor Bronze	Tin
Half Lock Contact	Phosphor Bronze	Tin